

# CliniMix® Mini Lead Safe™ 1/2" Thermostatic Mixing Valve

Product Code: 201.71.00.00

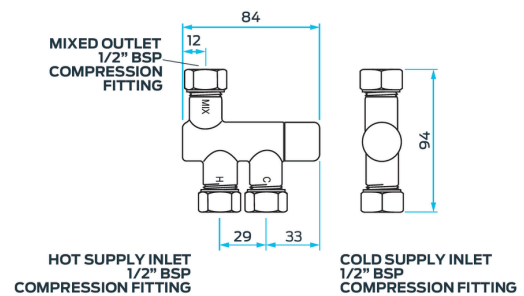

Our Australian Made Galvin CliniMix® range of thermostatic mixing valves (TMVs), powered by RMC Reliance Valves, is designed to protect the most vulnerable from scalding or cold water shock by providing tempered water to the desired outlets that comply with the relevant Australian Standards.

Suitable for health and general applications.



## Features

- Manufactured using Lead Safe™ DZR Brass with less than 0.25% lead content\*
- Ultra compact design for easy fitting under sink, behind basin shroud and close to tapware
- Thermal flush activation incorporated within headworks for superior flush capabilities
- Wall mounting bracket included
- In the event of either hot or cold water supply failure the valve will shut down, quickly restoring flow when normal conditions resume
- Water temperature is established at plus or minus 2 degrees even during water pressure or temperature fluctuations
- Suitable for installation in low-pressure systems and will operate with working pressure as low as 20kPa

- Can be installed in any configuration with the water outlet in the horizontal or vertical position, and inlet connections can be rotated to suit inlet pipework

### Technical Information

- Watermark: AS 4032.1 Lic 1593
- Dynamic Inlet Pressure (kPa)<sup>1</sup>: 20 Min - 500 Max
- Static Supply Pressure (kPa): 1600 Max
- Hot Supply Temperature (°C): 50 Min - 90 Max
- Cold Supply Temperature (°C): 5 Min - 30 Max<sup>2</sup>
- Hot to Mix Temperature Differential (°C): 7 Min
- Outlet Temperature Range (°C): 35 Min - 45 Max (+/-2)
- Minimum Flow Rate (LPM): 2 Min
- Maximum Flow Rate (LPM): 12LPM @300kPa pressure loss as per Flow Sizing Graph
- Inlet size: 1/2" BSP compression fitting
- Outlet size: 1/2" BSP compression fitting
- Construction: Lead Safe™ DZR Brass
- Finish: Chrome

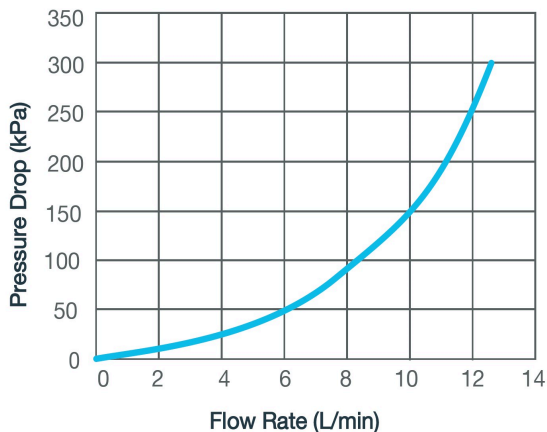

1) AS 3500.4 clause 1.9.4.2 - The dynamic pressure differential between hot and cold supplies when mixed at a thermostatic mixing valve shall not exceed 10%.

2) Where cold inlet temperature may exceed recommended range due to seasonal variation, a 5°C temperature differential between the inlet cold supply and outlet mixed temperature setting must be maintained.

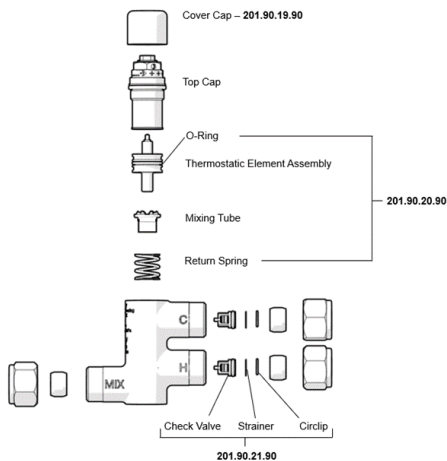



## Environmental Sustainability

We are ISO 14001 certified and take sustainability seriously. Our products are environmentally responsible designed to be healthier for users, save water and/or energy, and minimise carbon footprint. Our target is to reduce our carbon footprint by 25%, and the use of non-recyclable/non-compostable materials across the company (e.g. plastics) by 50%.

## Warranty

Galvin Engineering products are covered under our Manufacturer's Warranty. Galvin Engineering products must be installed in accordance with the installation instructions and in accordance with AS 3500 and NCC Volume Three, relevant Australian Standards and local authorities applicable to product being installed. Water and electrical supply conditions must also comply to the applicable national and/or state standards, failing to comply with these provisions may void the product warranty and affect performance of the product.

Please visit [www.galvinengineering.com.au](http://www.galvinengineering.com.au) to view the full warranty, our Installation Compliance and Maintenance & Cleaning information as well as any other additional information.

While all reasonable care has been taken in compiling the information in this document, the designs, dimensions and products shown are indicative only and should not be relied upon without our prior approval. Due to our policy of continuous development, we reserve the right to alter any details of specifications or products without notice. All information, drawings, technical specifications and product designs remain the property of Galvin Engineering Pty Ltd.

Our Lead Safe™ product range is compliant with the Lead Free Requirements of the NCC 2022 Vol. Three, Clause A5G4(2) and NSF/ANSI 372.

Within Australia: **1300 514 074**  
Outside Australia: P: +61 (0)8 9338 2344  
[sales@galvinengineering.com.au](mailto:sales@galvinengineering.com.au)  
[www.galvinengineering.com.au](http://www.galvinengineering.com.au)



**A family  
owned  
Australian  
business**

